

## How to do Scroll on iPhone?

The scroll function was added to the accessibility on IOS 13.5.1. So first, please update the IOS version on your iPhone to the latest new version IOS 13.5.1.

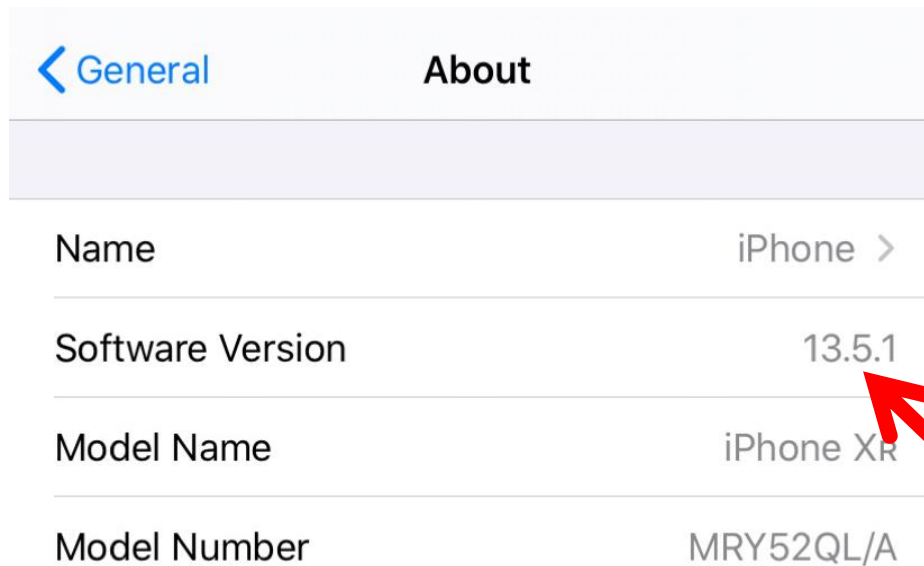

After connecting GlassOuse with iPhone, please follow the steps to click and perform the operation to add the scroll function :)

1. Find and Click Accessibility in Settings

2. Find and Click Touch in Accessibility

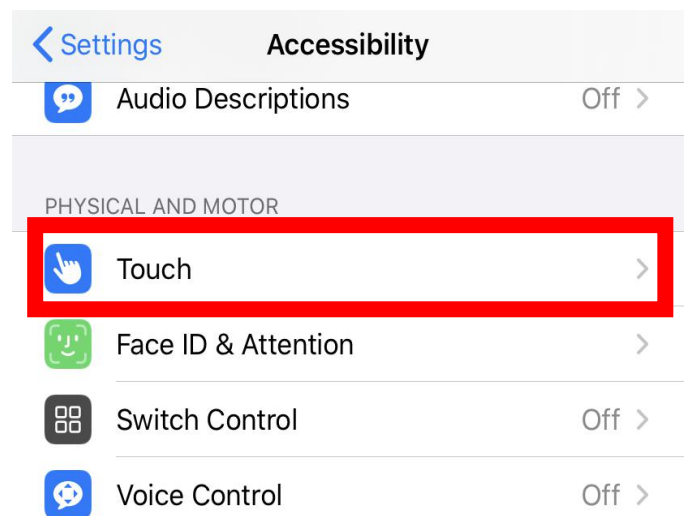
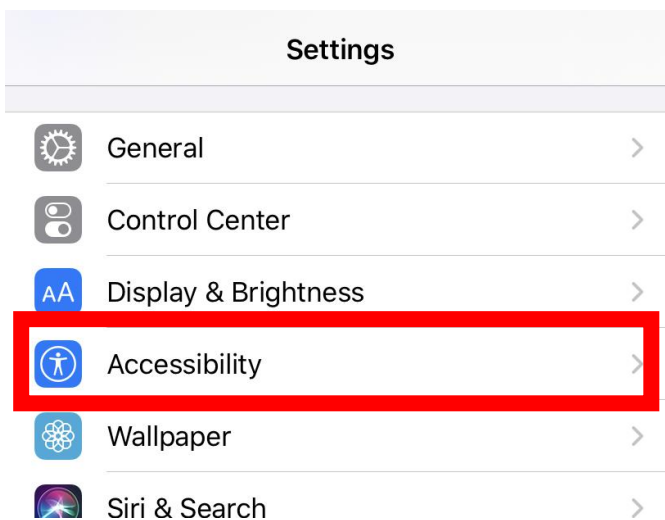

### 3. Find and Click AssistiveTouch in Touch



### 4. Find and Click Customize Top Level Menu in AssistiveTouch



### 5. Add the icon of Scroll

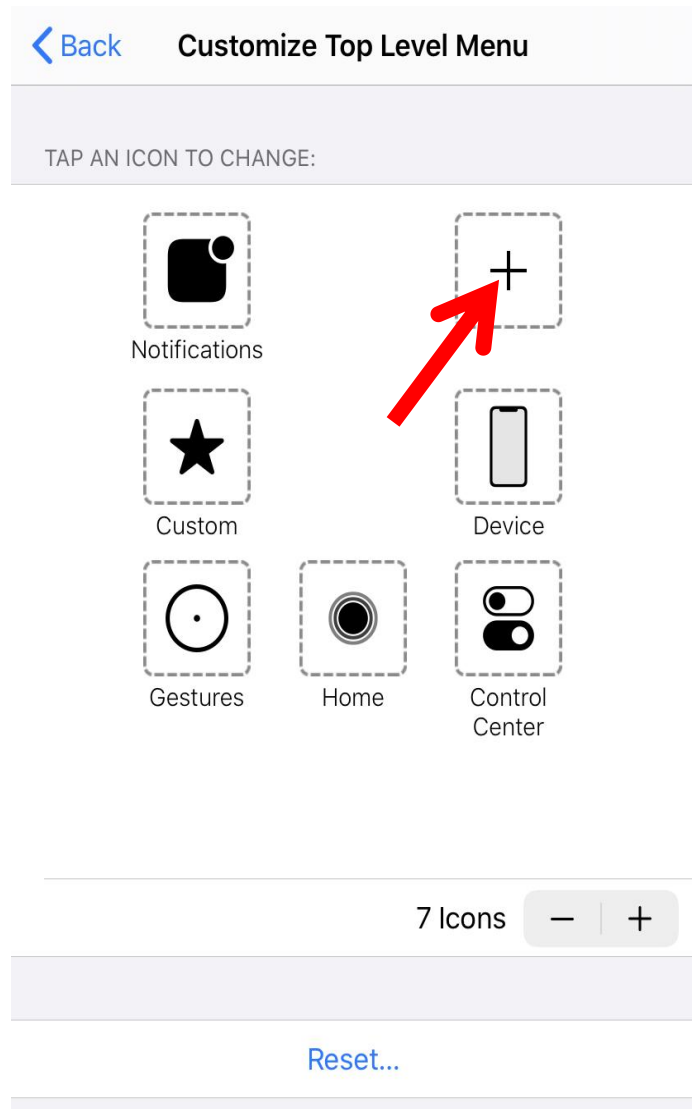
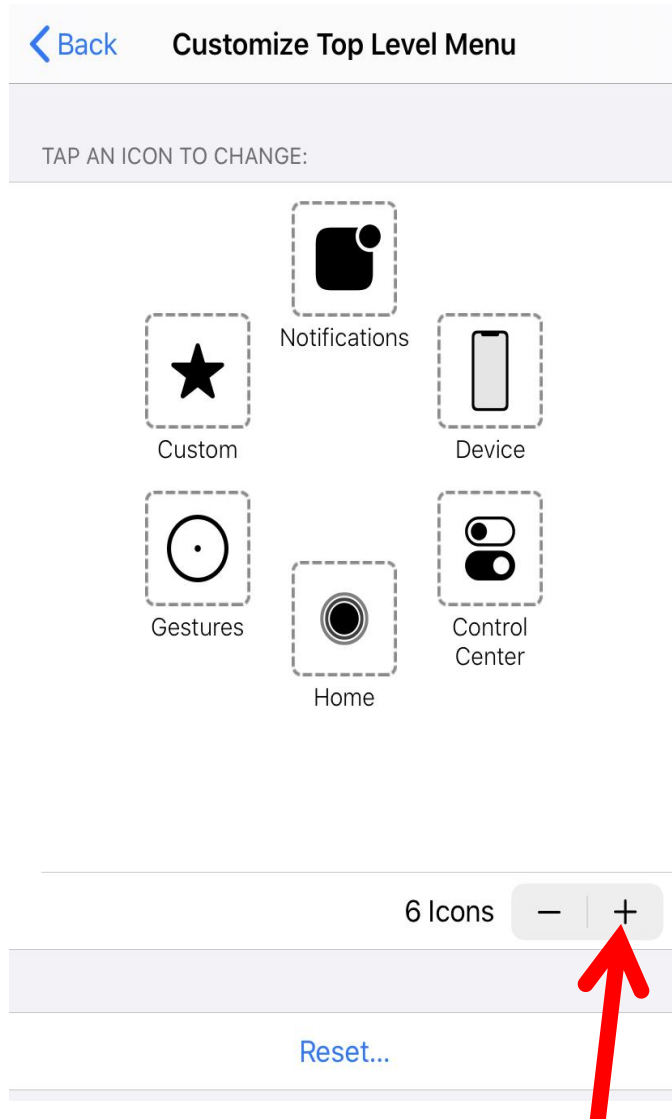

## 6. Find and Click Scroll

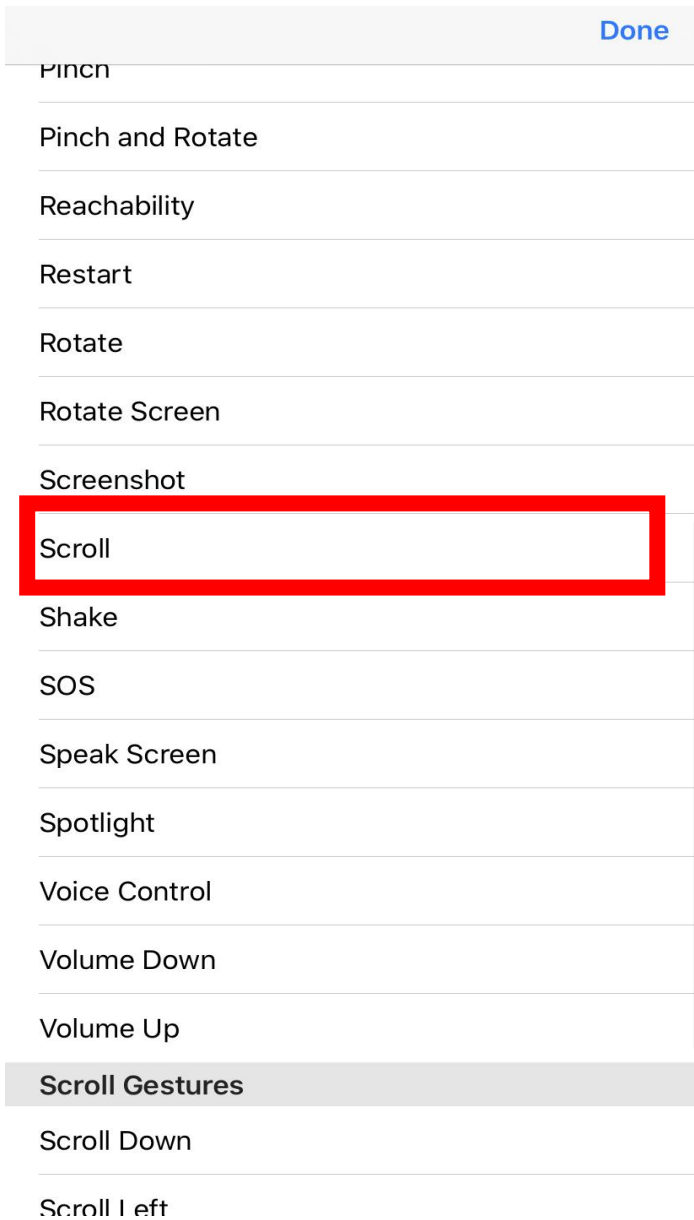

## 7. Add the Scroll successfully! We can find it in the Menu and use it in the AssistiveTouch dot!

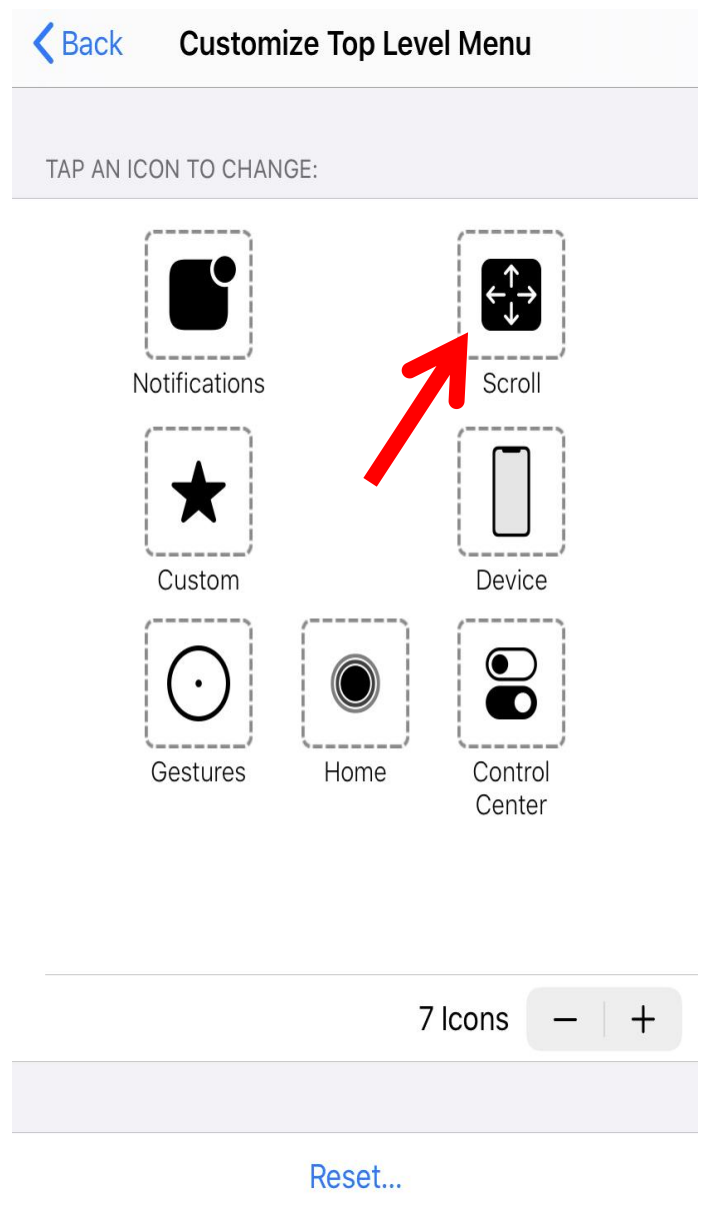

**Done! Open the AssistiveTouch Dot and Enjoy scrolling with GlassOuse!!!**

